

MARQUIS

Pier

Customer name _____

PO# _____

Salesperson _____

Store _____

1 Configurations Standard features: soft close drawers

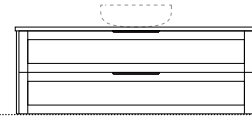
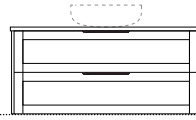
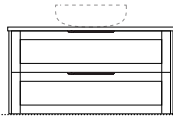
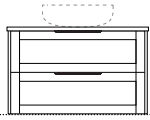

Wallmount height

Kick/leg height

Pier 1
600mm
centre bowl

Pier 2
750mm
centre bowl

Pier 3
900mm
centre bowl

Pier 4
1200mm
centre bowl

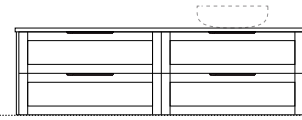
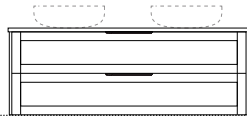
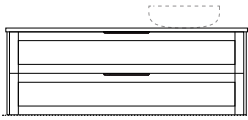

Wallmount height

Kick/leg height

Pier 5
1200mm
off centre bowl

Pier 6
1200mm
Double bowl

Pier 7
1500mm
off centre bowl

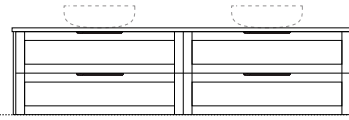
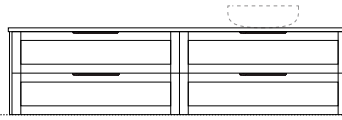
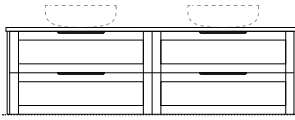

Wallmount height

Kick/leg height

Pier 8
1500mm
double bowl

Pier 9
1800mm
off centre bowl

Pier 10
1800mm
double bowl

2 Base options

Wallmount LED lighting under vanity

2 Cabinet finishes Vertical grain only

Natural Oak

Antico Oak

Black Ply

Coastal Oak

Empire Oak

Florentine Walnut

Prime Oak

Tasmanian Oak

Angora Oak

Notaio Oak

Bottega Oak

Estella Oak

Ligurian Walnut

Quartiera Maple

Boston Oak

3 Handles (top pull handles only. For full range of handles, see marquis.com.au/handles-legs)

Handle name: _____ **No Handle** Do not drill. Attach your own.

4 Top

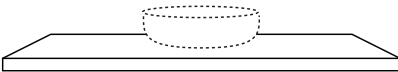

Above Counter Basin only

1 tap hole 3 tap holes No tap holes

12 o'clock 10 o'clock 2 o'clock

Select basins from Marquis Bathroom Book. Note: Taphole options will vary. Refer Marquis office

Top finish

Symphony colour _____

Caesarstone colour _____

Dekton colour _____

Marquis above counter basin range

Basin name _____

Additional info _____

Customer signature _____

Date _____