

COMMERCIAL
PRODUCTS



Nero

Claudia Range

Following extensive research, design and modification, Claudia was born as our first Sensor Mixer tap. A perfect illustration of a high-end sensor tap. With the latest sensor technology, visual display panel, unique shape and abundant colour choices, Claudia is an outstanding addition to our familf.







Hands Free For Hygiene Life

Claudia is controlled by an intelligent infrared sensing and controlling system. A hands-free control mode brings us a hygiene life.



Superfast Sensing Control

We have improved the sensing time to only 0.6 seconds, this not only brings you a perfect experience, it also saves our precious water resources to advocate sustainable development.



Mix Control Function

Unlike other sensor taps, Claudia is a Sensor Mixer Tap. You are able to control flow temperature by turning the hand wheel on right side.



Led Temperature Display

Designed with safety in mind. There is a LED temperature display on the face-panel of Claudia, to display the instant flow temperature accurately



Ultra Low Power Consumption

Claudia gives 100 uses, per day per year, for only the cost of 4 pcs AA batteries.

Touch Control Mode

Claudia is so much more than a sensor tap. The face-panel has an on/o touch control for getting continuous water flow. There is a 60 seconds limited flow time pre set for safety, and sustainability.





Chrome

Matte Black

Gun Metal

Brushed Gold

Brushed Bronze

Brushed Nickel



6 Different Finishes

We have developed 6 different on trend finishes for Claudia. Every tap has been meticulously coloured with the latest PVD technology. This makes Claudia full of advanced visual properties. So many colour choices so Claudia matches every bathroom space very easily. Let Claudia Sensor Mixer be a part of your designer lifestyle.

Easy Installation

Only 3 steps for set up and use
Claudia has modularised components making it
easy to set up and use,
whilst keeping to it's minimalist design.





NR222101CH

Sensor Mixer
Wels Rating: 6 Star, 5L/Min

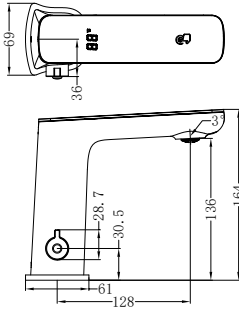

NR222101MB

Sensor Mixer
Wels Rating: 6 Star, 5L/Min

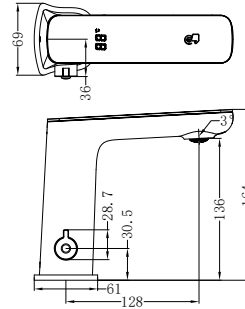

NR222101BN

Sensor Mixer
Wels Rating: 6 Star, 5L/Min

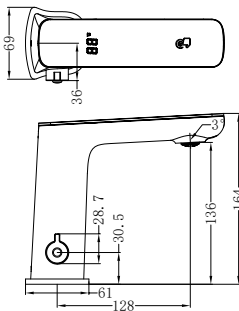

NR222101BZ

Sensor Mixer
Wels Rating: 6 Star, 5L/Min

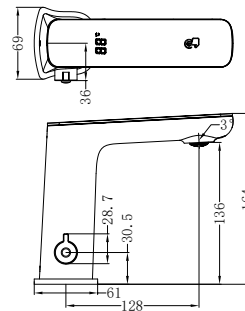



NR222101GM

Sensor Mixer
Wels Rating: 6 Star, 5L/Min

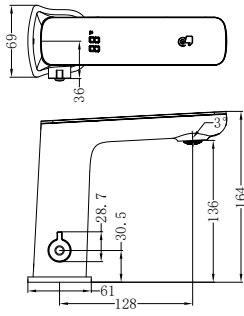

NR222101BG

Sensor Mixer
Wels Rating: 6 Star, 5L/Min

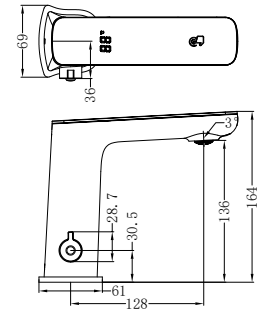



NR222102CH

Sensor Mixer
Wels Rating: 6 Star, 5L/Min

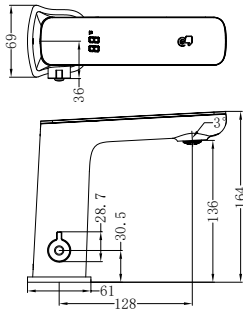

NR222102MB

Sensor Mixer
Wels Rating: 6 Star, 5L/Min

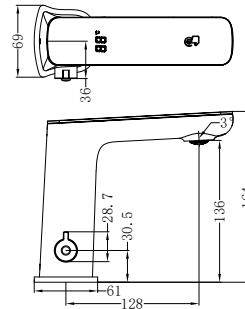

NR222102BN

Sensor Mixer
Wels Rating: 6 Star, 5L/Min

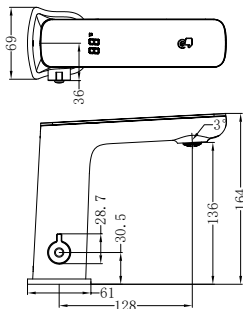

NR222102BZ

Sensor Mixer
Wels Rating: 6 Star, 5L/Min

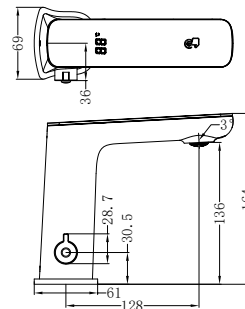



NR222102GM

Sensor Mixer
Wels Rating: 6 Star, 5L/Min

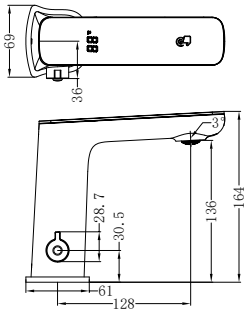

NR222102BG

Sensor Mixer
Wels Rating: 6 Star, 5L/Min

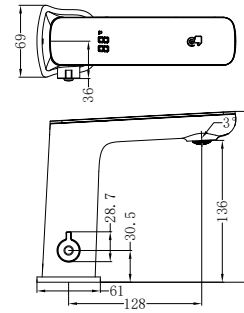







NR401MB

Mecca Wallmount Sensor Tap
Wels Rating: 6 Star, 6L/Min



NR401GM

Mecca Wallmount Sensor Tap
Wels Rating: 6 Star, 6L/Min



NR401CH

Mecca Wallmount Sensor Tap
Wels Rating: 6 Star, 6L/Min



NR401BN

Mecca Wallmount Sensor Tap
Wels Rating: 6 Star, 6L/Min



NR401BZ

Mecca Wallmount Sensor Tap
Wels Rating: 6 Star, 6L/Min



NR401BG

Mecca Wallmount Sensor Tap
Wels Rating: 6 Star, 6L/Min



NR401MW

Mecca Wallmount Sensor Tap
Wels Rating: 6 Star, 6L/Min

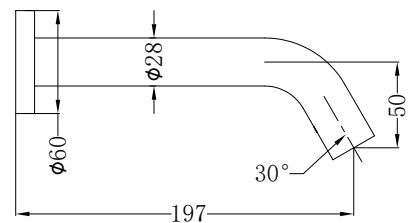



NR402MB

Mecca Sensor Tap
Wels Rating: 6 Star, 6L/Min



NR402GM

Mecca Sensor Tap
Wels Rating: 6 Star, 6L/Min



NR402CH

Mecca Sensor Tap
Wels Rating: 6 Star, 6L/Min



NR402BN

Mecca Sensor Tap
Wels Rating: 6 Star, 6L/Min



NR402BZ

Mecca Sensor Tap
Wels Rating: 6 Star, 6L/Min



NR402BG

Mecca Sensor Tap
Wels Rating: 6 Star, 6L/Min



NR402MW

Mecca Sensor Tap
Wels Rating: 6 Star, 6L/Min

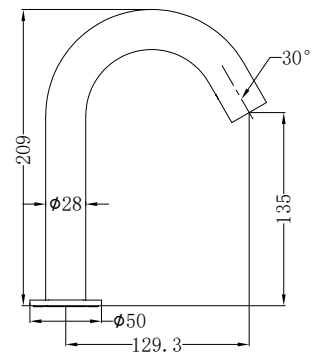



NR403CH

Bianca Sensor Tap
Wels Rating: 6 Star, 6L/Min

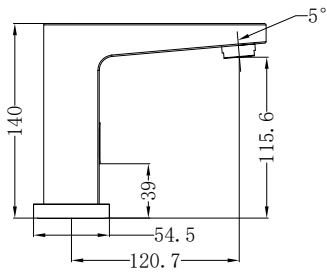

NR403MB

Bianca Sensor Tap
Wels Rating: 6 Star, 6L/Min

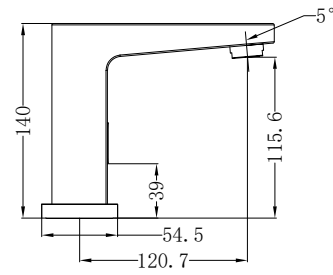

NR291201CH

Classic Push Tap
Wels Rating: 5 Star, 6.5L/Min

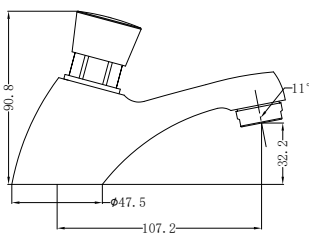

Warranty Policy

1. Goods sold by are made to the highest industry standards and quality, which is reflected in the warranty against defects.
2. This warranty policy is issued by Nero Bathrooms International Pty Ltd t/as Nero Tapware ABN 57 148 833 989 (Supplier) of 11-13 Buontempo Road Carrum Downs, Victoria, Australia, telephone (03) 8786 3170, email warranty@nerotapware.com.au.
3. The following warranty periods apply to goods purchased after 1 December 2019:

| Category | Warranty Period | Warranty Details |
|---|-----------------|---|
| Commercial Range & Claudia Sensor Mixer | 1 year | <ul style="list-style-type: none"> 1 year Replacement products or parts & Labour |

4. The warranty period commences from date of purchase, or for new buildings from date of handover.

5. To make a warranty claim, the customer must either contact the seller from which the customer purchased the goods, or contact the Supplier directly by telephone on (03) 8786 3170, by email at warranty@nerotapware.com.au, by fax at (03) 8786 3175 or using the online claim form at <https://nero-warranty.tradieconnect.me/admin/custom/api/warrantyform1/?service=2600&-serviceselect=2600&status=5>. The claimant must provide proof of purchase or equivalent documentation such as handover documentation for new homes.

6. The expense of claiming on the warranty will be borne by the customer claiming on the warranty.

7. This warranty covers the repair or, at Supplier's option, replacement of any goods which are defective through faulty manufacture or materials, free of charge and labour. The Supplier reserves the right to alter, or amend this warranty offer in writing at any time. The Supplier reserves the right to provide minor components (eg. Handles, aerators, buttons, dress rings, spindle/cartridges and seals) as 'Parts Only' to the customer. This warranty does not cover any claims for labour, additional products or parts associated with allegedly faulty goods for work not approved in advance in writing by the Supplier.

8. For installed goods, the Supplier requires adequate access to assess the goods, fittings and fixtures to assess any warranty claim, and to undertake any warranty repairs. The Supplier will not be responsible for any consequential damage or costs where adequate access to goods, fittings or fixtures is not provided.

9. For discontinued or unavailable goods, the Supplier may replace the goods with equivalent current or available goods, using best endeavours to match the appearance and specifications of the original goods.

10. Supplier's obligations under warranty are limited to the repair or, at Supplier's option, replacement of any products of any products which are defective through faulty workmanship or materials. To the extent permitted by law, Supplier will not be liable for any loss to furniture, floor coverings, walls, fixtures or any consequential loss of any kind caused by any defect in the product components.

11. This warranty does not cover defects caused by or arising from any of the following:

- 11.1. goods installed by a person other than a licenced lumber. This does not apply to bathroom accessories such as towel rails, shelves, etc;
- 11.2. goods not installed to relevant national standards or state regulations;
- 11.3. tapware exposed to water pressures and/or temperatures that exceed stated limitations as per the standard installation instructions. Note: AS/NZS 3500.1:2003 specifies 500kPA maximum water supply pressure at any outlet within a building for new installations;
- 11.4. fitting of other devices to the outlet of tapware (eg water filters);
- 11.5. fitting of in tap body or end of line water flow regulating devices that have not been approved by Supplier;
- 11.6. products used for incorrect applications, non-potable water, etc;
- 11.7. damage as a result of obstruction due to inadequate flushing of system before use;
- 11.8. service, repairs or other non-standard replacement parts previously undertaken without Supplier's prior written approval;
- 11.9. damage to finishes by adhesives, sealant, etc;
- 11.10. damage to finishes which arise from installation or post-installation use;
- 11.11. failure to observe manufacturer's care and cleaning instructions;
- 11.12. improper or abusive use of product and/or damage resulting from misuse, accident or neglect.

12. Should any warranty claim be made and service attended to by the Supplier or its authorised service agent, and the fault is due to a cause expressly excluded from this warranty above, the Supplier reserves the right to charge a service fee for attending and/or any work carried out.

13. This warranty is in addition to customer's rights under the Australian Consumer Law.

14. Our goods and services come with guarantees that cannot be excluded under the Australian Consumer Law. For major failures with the service, you are entitled:

- 14.1. to cancel your service contract with us; and
- 14.2. to refund for the unused portion, or to compensation for its reduced value. You are also entitled to choose a refund or replacement for major failures with goods. If a failure with the goods or a service does not amount to a major failure, you are entitled to have the failure rectified in a reasonable time. If this is not done you are entitled to a refund for the goods and to cancel the contract for the service and obtain a refund of any unused portion. You are also entitled to be compensated for any other reasonably foreseeable loss or damage from a failure in the goods or service.

Please note:

Nero Tapware reserves the right to modify specifications shown, or delete products from their range without prior notification.

Nero Bathrooms International Pty Ltd
info@nerotapware.com.au
www.nerotapware.com.au