

# Opal Progressive Shower System Separate Plate With Spout Trim Kits Only

Nero

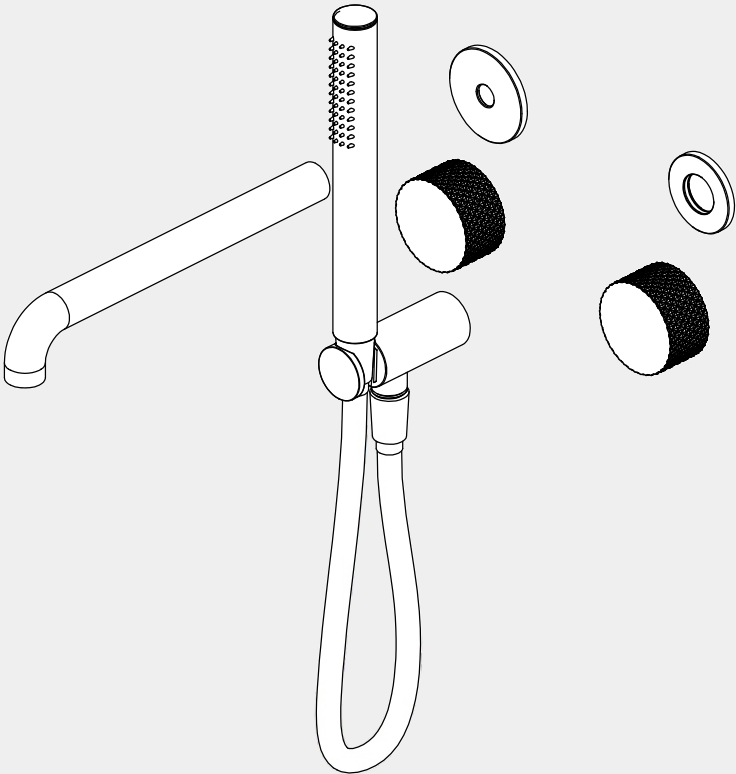

Versions:202401

Drawing	Specifications	Packaging Includes			
	<p><b>Watermark License</b> WM-060073</p> <p><b>Temperature Rating</b> Min 1°C-Max 75°C</p> <p><b>Pressure Rating</b> Min 150kpa - Max 500kpa</p>	<p>2x Plates 1x Spout 1x Hand- Wheel 1x Diverter Knob 1x Hand Shower( Within Check- Valve) 1x 1m PVC Hose 1x Shower Bracket</p>			
	<p><b>Finish &amp; SKU</b></p> <table><tr><td> Graphite NR252003b(230/250)tGR</td><td> Brushed Bronze NR252003b(230/250)tBZ</td></tr><tr><td> Brushed Gold NR252003b(230/250)tBG</td><td> Brushed Nickel NR252003b(230/250)tBN</td></tr></table>	Graphite NR252003b(230/250)tGR	Brushed Bronze NR252003b(230/250)tBZ	Brushed Gold NR252003b(230/250)tBG	Brushed Nickel NR252003b(230/250)tBN
Graphite NR252003b(230/250)tGR	Brushed Bronze NR252003b(230/250)tBZ				
Brushed Gold NR252003b(230/250)tBG	Brushed Nickel NR252003b(230/250)tBN				

\*Dimensions are nominal measurements only.

\*Dimensions are nominal measurements only.

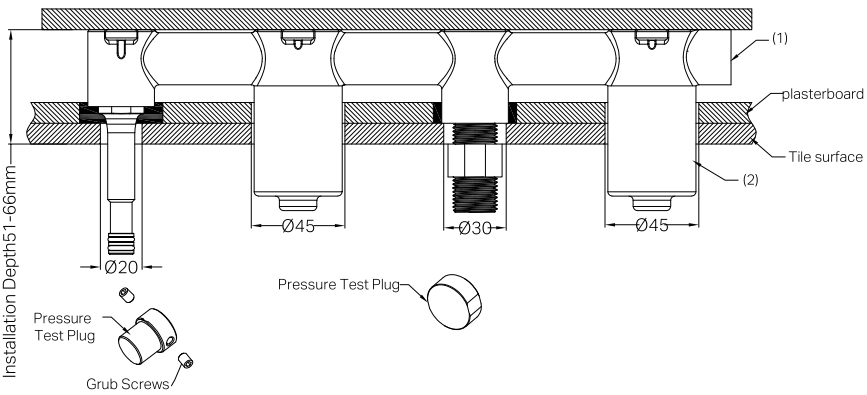

1. Install tiles and drill holes with diameters of Ø20, Ø45, Ø30, Ø45.  
2. Remove the pressure test plug.  
3. Assemble the cutting gauge onto the mixer body, make it flush with the tile surface, and trim off any excess part after assembly.

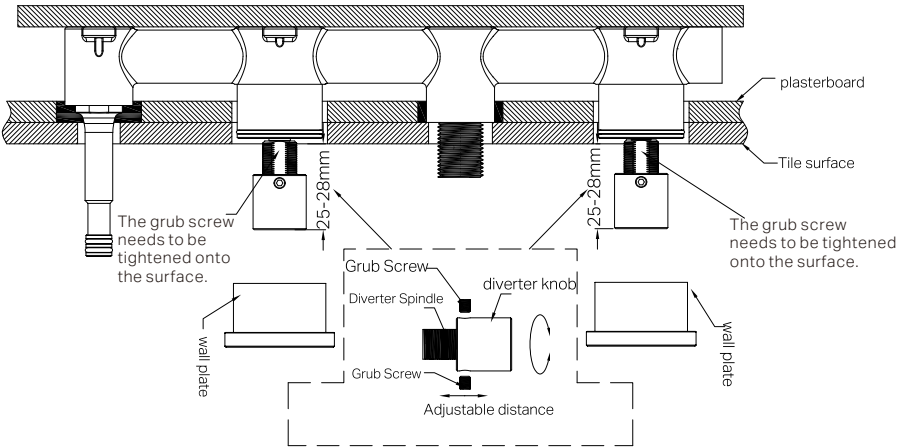

5. Adjust the distance between the Diverter knob and the tile surface to 25-28mm, as shown in the diagram.  
6. Place the wall plate onto the mixer body.

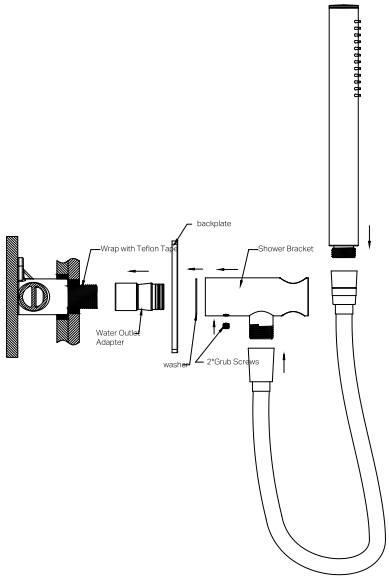

8. Thread the water outlet adapter onto the in-wall body, and seal with Teflon tape.  
9. Assemble the Backplate, washer, and shower bracket onto the main body, then secure with screws.  
10. Attach the shower hose and hand shower, securing them in place.

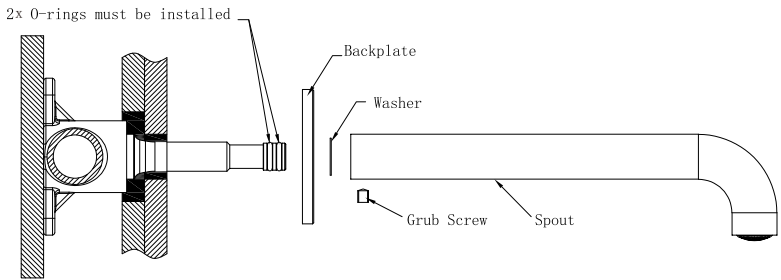

12. Assemble the backplate, washer, and spout onto the mixer body, then secure with grub screws.  
Please Note: Waterproofing is required.

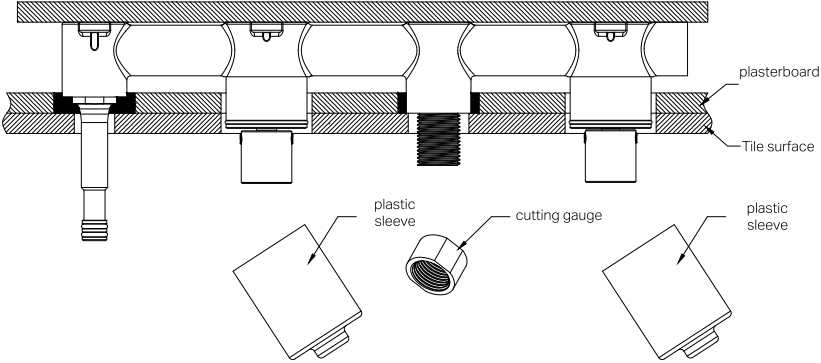

4. Remove the cutting gauge and protective sleeves.

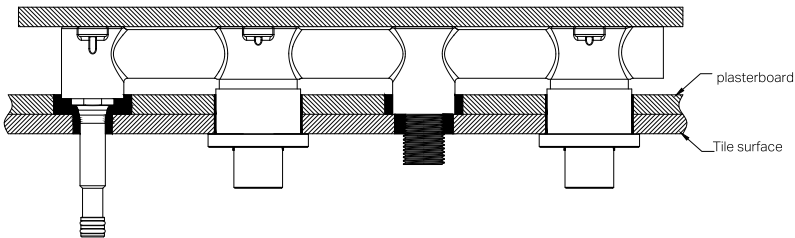

7. Apply waterproofing in the gap between the ceramic tile and the water outlet.

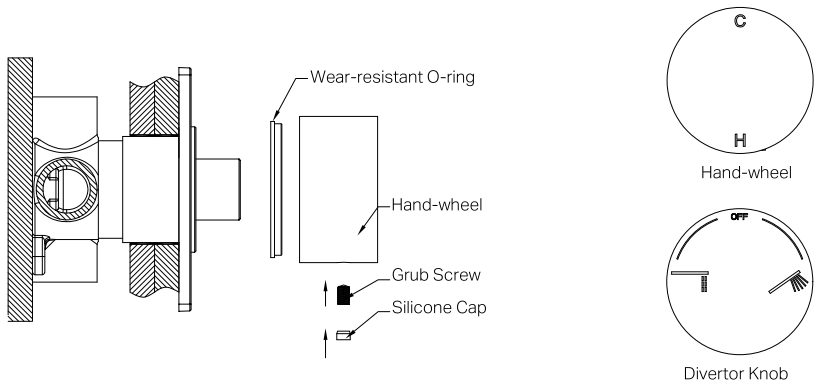

Follow step 11 to install the Hand-wheel and the Diverter Knob

11. Attach the wear-resistant O-ring, hand-wheel/ Diverter knob, grub screw, and silicone cap, securing them in place.

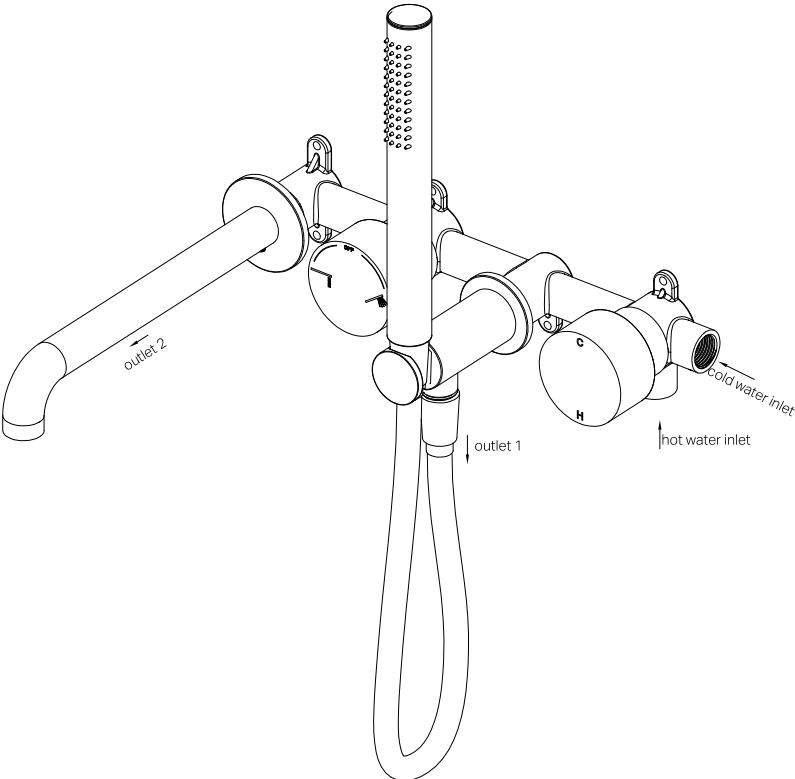

13. Installation is now complete. Test for leaks.

Nero

