

# LAFEME

## Instruction manual

AUTOLUX ST23

Floor Mounted Smart Toilet

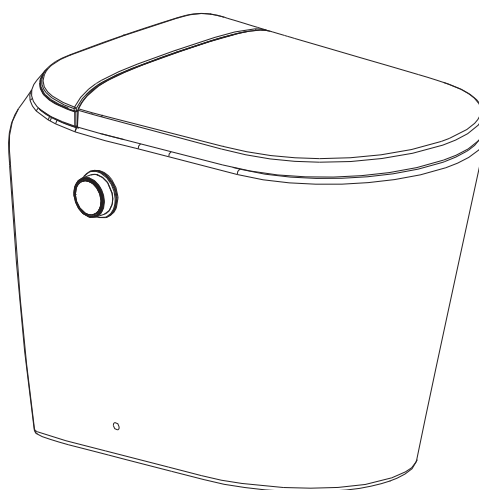

# Scope of use

Installation is subject to the requirements of the applicable regulatory authority, the National Construction Code Volume Three -Plumbing Code of Australia, associated reference standards as applicable at the time and AS/NZS 3500. This toilet has air-gap assessed that is compliant to AS 2845.2 - water supply backflow prevention. Please Note: Local regulations may vary, so it's important to confirm with local authorities whether an RPZ (Reduced Pressure Zone) value is required.

To install, tighten each inlet connection to 10 N.m Max. torque. Leakage test shall be done before first use. Only a qualified plumber and electrician should be used for Installation and maintenance.

Smart Toilet body: PP/UF

Water temperature: 4-35°C

Operating Pressure: 0.1-0.75 Mpa

Only watermark certified components could be used to match with this Smart Toilet bidet seat.

- ※ Please read this manual thoroughly before using the product.
- ※ Please do not hesitate to contact us if you have any questions in the installation or usage.
- ※ Please safe keep this manual after reading.

# Contents

Safety precautions .....	1
Bill of material .....	4
Specification .....	5
Installation Tools .....	6
Parts name .....	7
Product installation .....	8
Introduction for remote control panel .....	13
Instruction for remote control Installation .....	14
Instruction .....	15
Knob control instruction .....	16
Other Functions instruction .....	17
Troubles shooting .....	18
Maintenance Service Sheet .....	19
Maintenance record .....	20



# Safety precautions

In order to avoid injury and property loss, please follow the safety warnings and precautions. Read this manual carefully before installation, and then install it in accordance with the instructions. After you have finished reading, please keep the instructions for the end user.

 **WARNING** It means that if you ignore this sign  
It may cause personal injury or property damage

 Below items are prohibited

 These are compulsory requirements

 <b>WARNING</b>	
 	<b>Make sure that this product is correctly attached to a grounded connection. (If the product is not grounded, it may introduce the risk of electric shock)</b>
	Please do not use a loose power connection, or it may cause electric shock or cause fire.
	Please do not spray detergent, water, cleaning agent in or around the power supply, this may cause electric shock or fire.
	Always use the specified supply voltage (240VAC, 50Hz), it is necessary to install a circuit breaker.
	Prior to the installation, a suitable electrical connection should be available, according to the current local legislation.
	<b>Rainwater, demineralized water, sea water or grey water are not suitable to operate this equipment. Operate with normal drinking water only.</b>
	Recommended water pressure is between 100-500Kpa Recommended water temperature is between 4-35°C
	Use only mild detergent and a soft cleaning cloth for cleaning the seat and surrounding pan, (Enjo or similar micro fibre cleaning products are suitable) Typical toilet cleaning procedures for inside pan are suitable. Bleach or chlorine-based products should not be left inside the pan with the seat shut or for prolonged periods.
	Standing on the seat, using the seat for a plank or any use outside of a typical weight not evenly distributed can cause damage to the seat and will void the warranty. The product must be installed by recognized professional tradespeople. i.e. Plumber and Electricians.
	Use only Watermark approved flexible hoses for this installation.
	Do not attempt to disassemble and/or repair the product without authorization, any work by non-professionals will void the warranty and may cause damage to the product.



## **WARNING**



Please stop using if the seat cover malfunctions  
Please cut off the power supply, and close the water-inflow valve to stop water supply if following cases happen:

Faults: Excessive heating; smoking;  
Abnormal sound and odour; Products cracks, damages; or blocked.

It may cause electric shock, injury, fire or indoor problems if you continue to use it when it is malfunctioning.

Please do not use gasoline, detergent, nylon brush and other non-neutral cleaning agent to clean the seat cover and other plastic parts. Otherwise, it may cause a chemical reaction or crack, which will lead to injuries and will not be covered under warranty.

## **WARNING**



Power supply should be cut off when the product is being serviced or under maintainance, or it may cause an electric shock or fire.

Please make sure that the power is correctly connected to the AC 220V/50Hz power socket, or it may cause electric shock or fire. must have an isolated circuit breaker.

Please turn off power before taking out seat or it may cause electric shock.

Please ensure the bathroom is ventilated to make sure the atmosphere is suitable, it is an electric appliance product, please do not install in the place with high moisture or somewhere easy to get wet. Otherwise, it may cause electric shock or fire.

Please close the water-inflow valve if water leakage, and ask the professional person to repair it, or it may lead the damage of products.

**THIS TOILET DOUCHE SEAT MUST BE INSTALLED WITH APPROPRIATE BACKFLOW PROTECTION CONFORMING TO THE NATIONAL CONSTRUCTION CODE - VOLUME THREE-PLUMBING CODE OF AUSTRALIA, ASSOCIATED REFERENCE STANDARDS AS APPLICABLE AT THE TIME AND AS/NZS 3500. THIS TOILET HAS AIR-GAP ASSESSED THAT IS COMPLIANT TO AS 2845.2 - WATER SUPPLY BACKFLOW PREVENTION. PLEASE NOTE: LOCAL REGULATIONS MAY VARY, SO IT IS IMPORTANT TO CONFIRM WITH LOCAL AUTHORITIES WHETHER AN RPZ (REDUCED PRESSURE ZONE) VALUE IS REQUIRED.**

## **WARNING**



Please turn off inlet valves , drain water out from toilet and cut the power when not using products for a long time. Please flush through the water when you use this product again, to prevent water quality problems, which will cause skin diseases. Otherwise , it may cause electric shock , injury or fire.

Please tighten each waterway connection when installing it or it may cause water leakage.

Please pay attention to socket and installation position.  
Please set the leakage protector in the socket circuit or insulation transformer (1.5 KVA-3KVA).  
Power socket installation location should at least 0.5 m above the floor, and keep away from objects out of water such as shower and bathtub. Otherwise it may cause electrical shock and/or electrocution risk.

Please turn off power before cleaning products and do not clean products with water directly or it may cause electric shock or fire.

Please put the product in the shade or the products may fade or cause discoloration on the surface.

Please increase indoor temperature and make sure the water is flowable before using to avoid damage in cold region, or it may cause products damaged or water leakage.

To prevent scalding users, the seat temperature will decrease automatically after seated 15mins.

Please make sure the power supply and inlet valves are turned off before taking cover off the seat, or it may cause electric shock or fire.

This appliance can be used by children aged from 8 years and above and persons with reduced physical, sensory or mental capabilities or lack of experience and knowledge if they have been given supervision or instruction concerning use of the appliance in a safe way and understand the hazards involved.

Children shall not play with the appliance.

Cleaning and user maintenance shall not be made by children without supervision.

The appliance is not to be used by persons (including children) with reduced physical, sensory or mental capabilities, or lack of experience and knowledge, unless they have been given supervision or instruction.

If the supply cord is damaged, it must be replaced by the manufacturer, its service agent or similarly qualified persons in order to avoid a hazard.

# Bill of material

## MAIN APPLIANCE

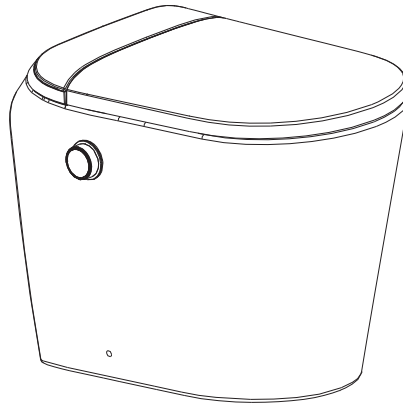

REMOTE CONTROL



REMOTE CONTROL  
HOLDER



REMOTE EXPANSION  
SCREW GROUP  
(EACH 2PCS)



DOUBLE-FACED  
ADHESIVE TAPE

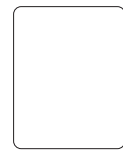

INSTRUCTIONS

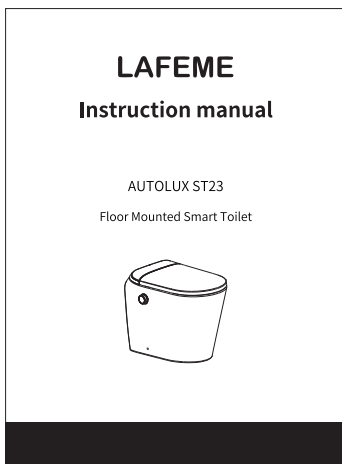

ALLEN KEY

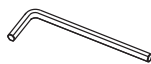

DECORATIVE  
COVER (2 PCS)



CERAMIC FIXED  
COMPONENTS  
(EACH 2 PCS)

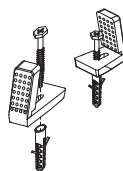

NYLON NUT  
(2 PCS)



GASKET  
(2 PCS)



DRAIN PIPE  
T3113  
(1 PC, INCLUDED)

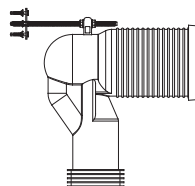

SCREW  
(2 PCS)



AAA BATTERY  
(2 PCS)



DRAIN PIPE  
T3103  
(1 PC, SOLD SEPARATELY)

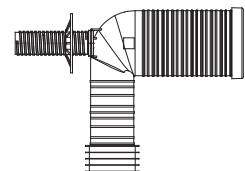

# Specification

Rated voltage		220-240V~ 50-60Hz
connector cable		About 500mm
Cleaning device	Outlet water temperature range	About 35°C-42°C、 or turn off the water temperature
	Nominal water consumption	4.5 L per full/ 3 L per half flush
Seat surface temperature		Room temperature-approx 38°C
Soft closing method of the cover and the seat (Some models do not have this function)		Slow closing mechanism
		Remote control
		Auto sensing
		Foot sensing
Rated power		1180W
Max. power		1630W
Indoor temperature		3°C-40°C
Water temperature		3°C-35°C
Water pressure		0.10MPa(static pressure) -0.75MPa(static pressure)
Waterproof grade		IPX4
Product size		593*395*500mm
Battery for remote control		AAA (2pcs)

\* Rated power: Under the conditions of ambient temperature  $20^{\circ}\text{C} \pm 5^{\circ}\text{C}$ , inlet water static pressure  $0.18\text{MPa} \pm 0.02\text{MPa}$ , and inlet water temperature  $15^{\circ}\text{C} \pm 1^{\circ}\text{C}$ , set the water volume, seat temperature, and water temperature to the highest level in turn, and turn on the feminine cleaning and continue to work stably for 60 seconds on average;

\* Maximum power: The maximum power at when the Feminine wash works for a cleaning cycle under the condition of ambient temperature  $23^{\circ}\text{C} \pm 2^{\circ}\text{C}$ , inlet water static pressure  $0.18\text{MPa} \pm 0.02\text{MPa}$ , inlet water temperature  $5^{\circ}\text{C} \pm 1^{\circ}\text{C}$  and the water volume, seat temperature and water temperature set is set to the highest.

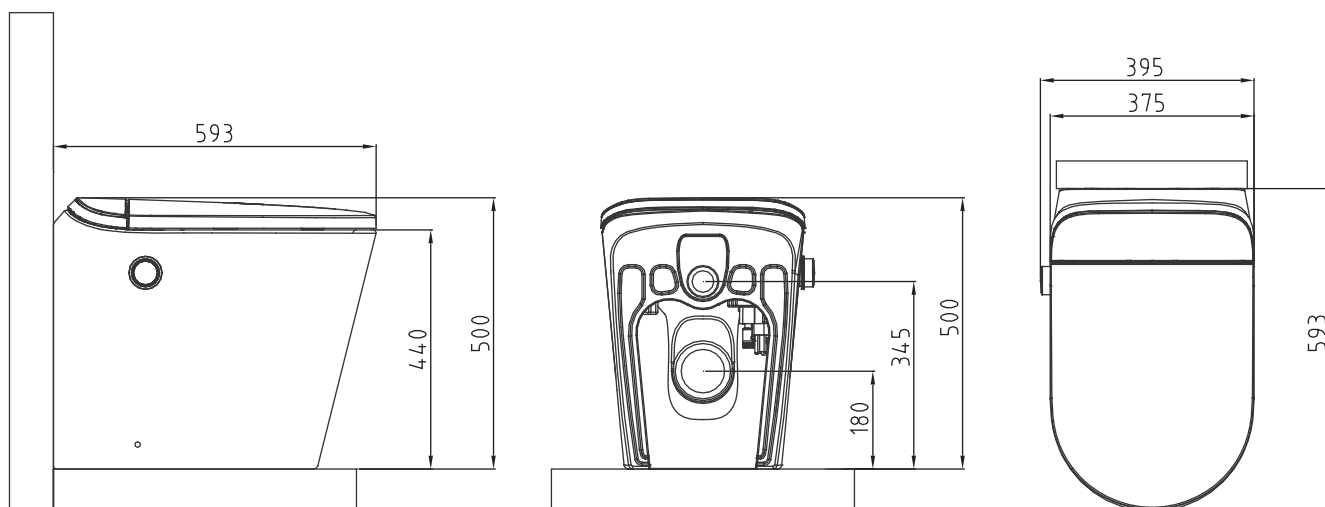

# Installation Tools

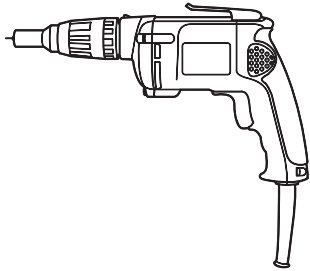

Percussion Drill

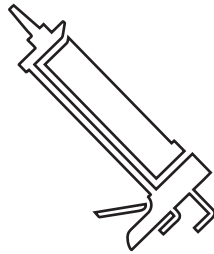

Caulk Gun

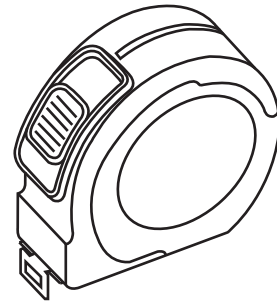

Tape

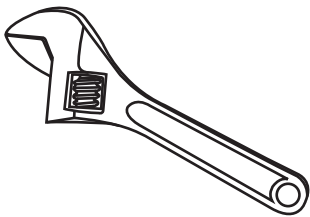

Adjustable Wrench

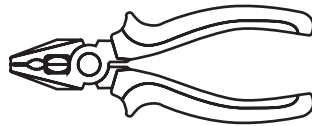

Pliers



Screwdriver

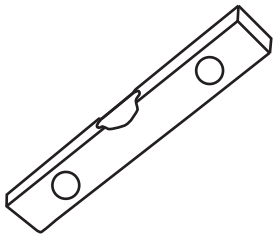

Spirit Level



Steel saw

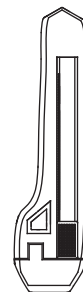

Utility Knife



Allen Key



pencil



file



Ruler

# Parts name

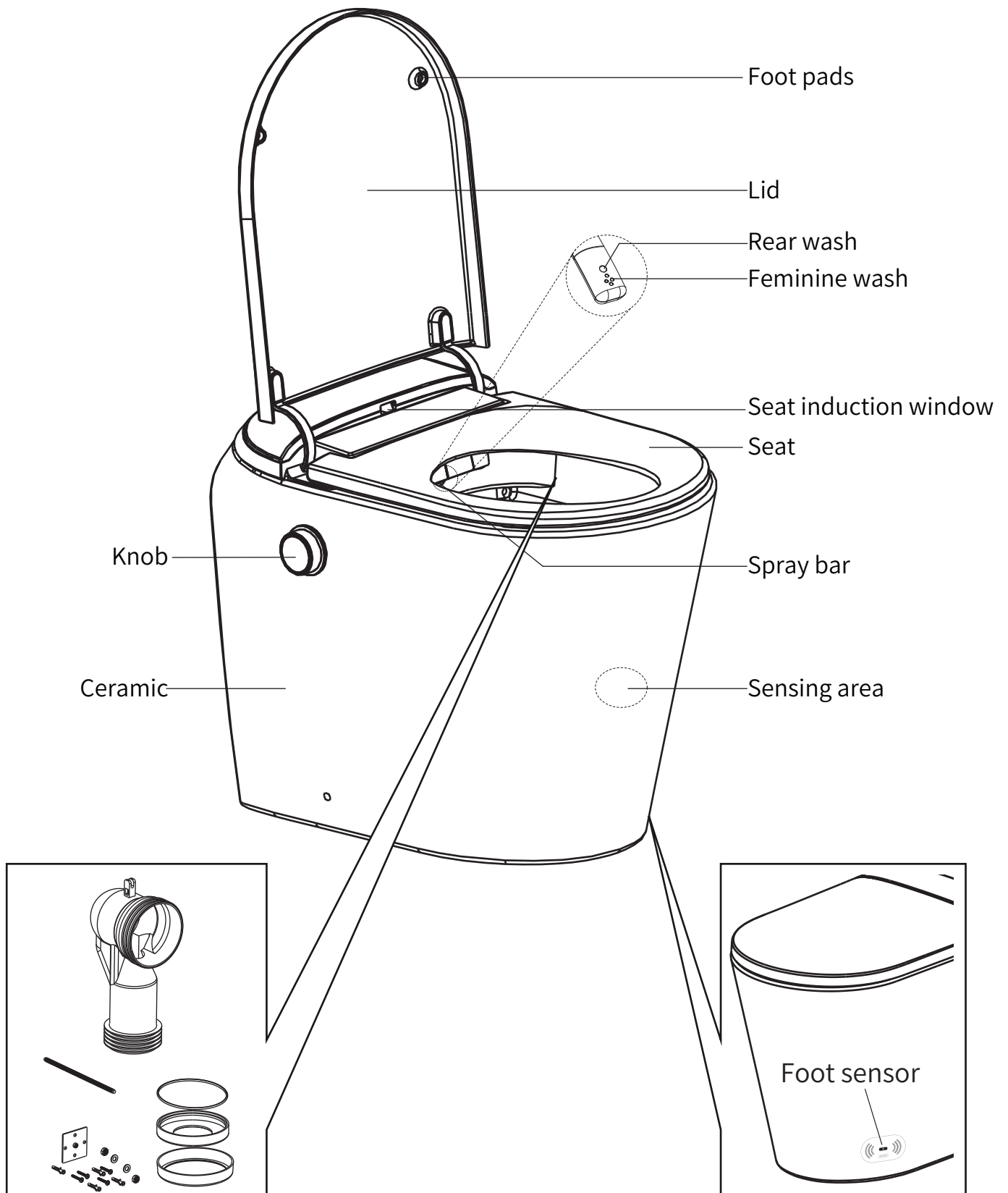

# Product installation

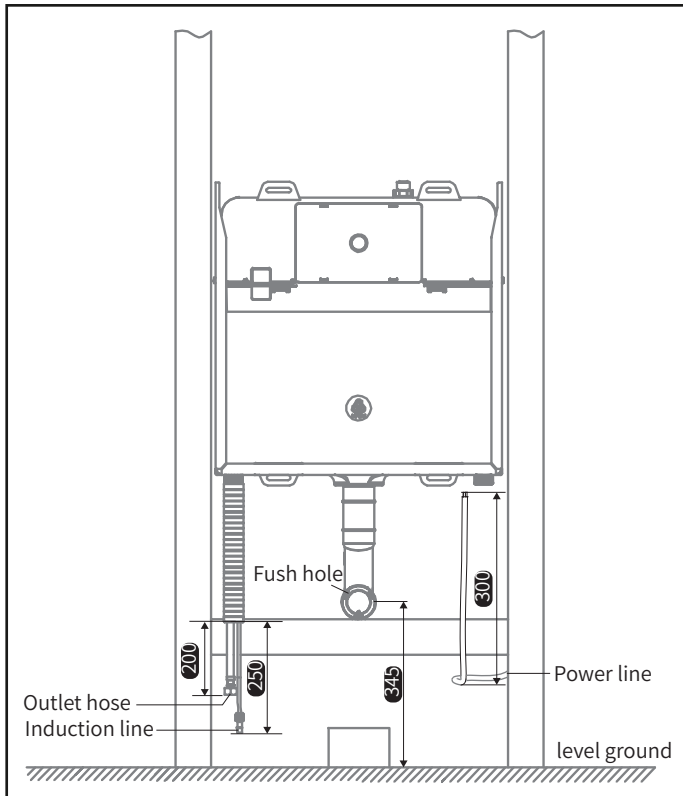

1. Fix the water tank frame with the outlet hose, power line and induction line exposed. Exposed size as the left ( as for water tank frame installation, please refer to according manual).

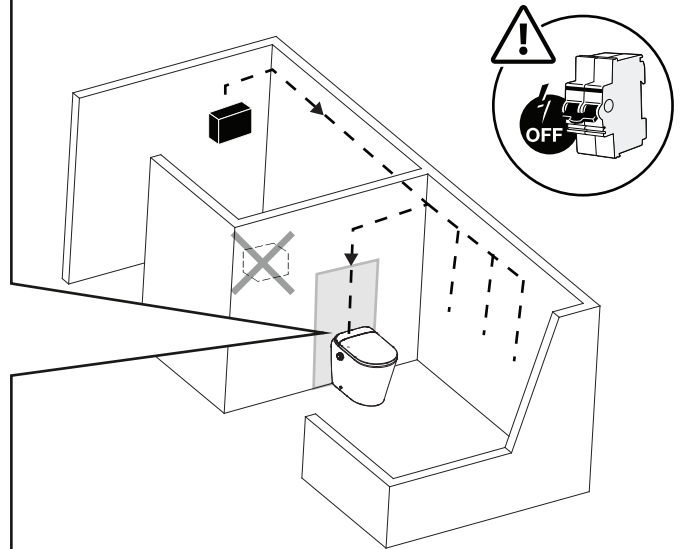

2. Connect the 1/2" thread in the side of the cistern to a 1/2" BSP wall elbow at the rough in position for water supply. Connect the water inlet pipe removed from the electronic cover in Step 3 to the water outlet pipe of the water tank to supply water

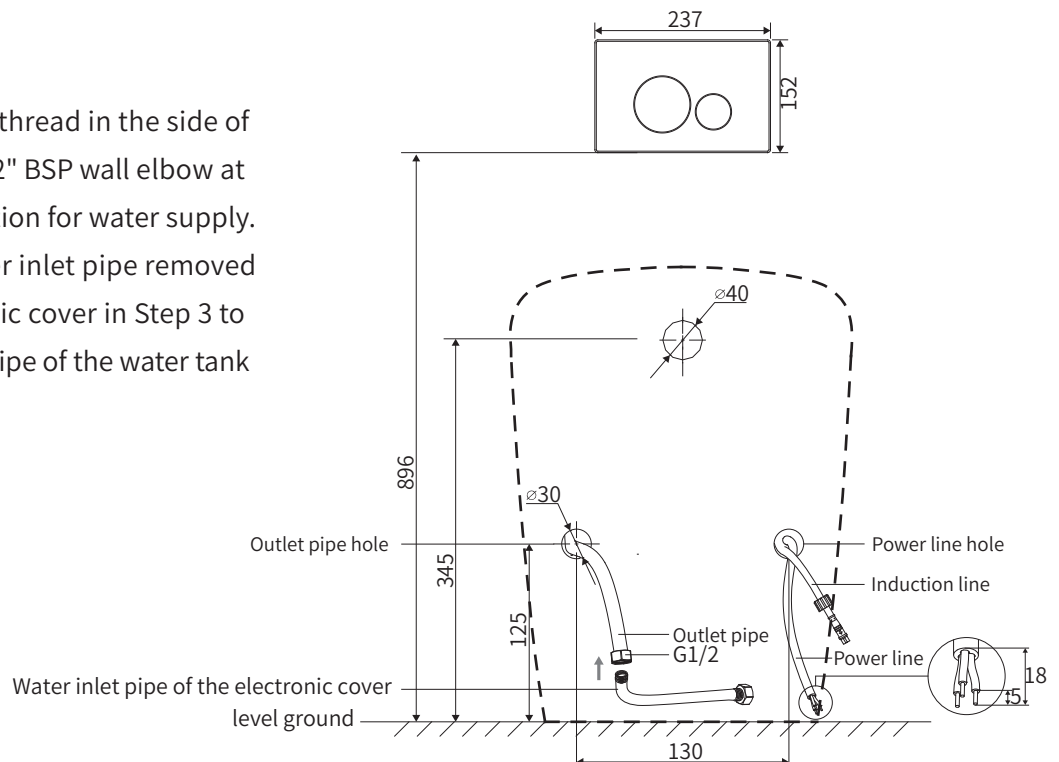

# Product installation

3. Open the lid and use a tool to remove the decorative screw caps (A new pair is in the spare part box).

Use screwdriver to undo the screws. Take out the electronic seat and cover and put them in a clean place and then remove the water inlet pipe of the electronic cover.

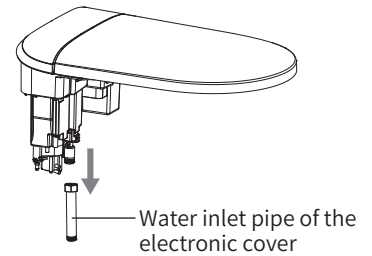
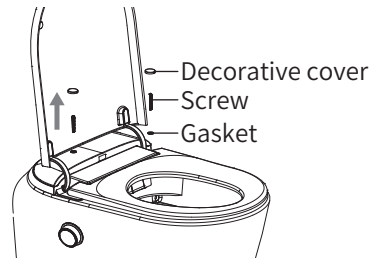

4. Take out the drain pipe fitting, and select the appropriate drain pipe fitting according to the actual pit distance L of the drain pipe.

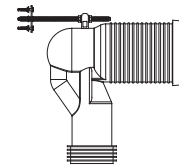
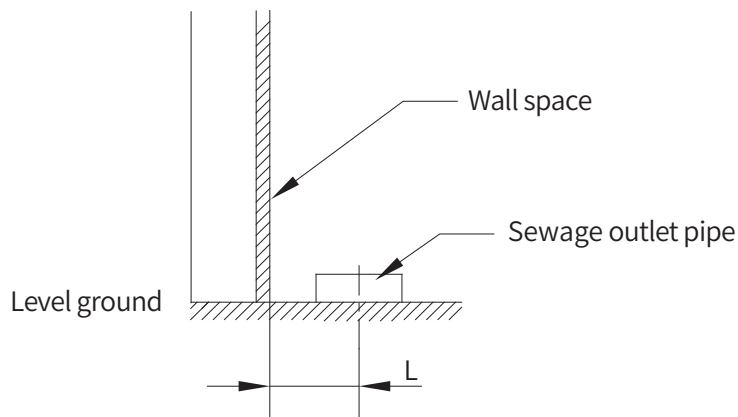

T3113  
(L=95-115)

5. Match the length of the drain pipe with the ceramic, and cut the excess pipe length.

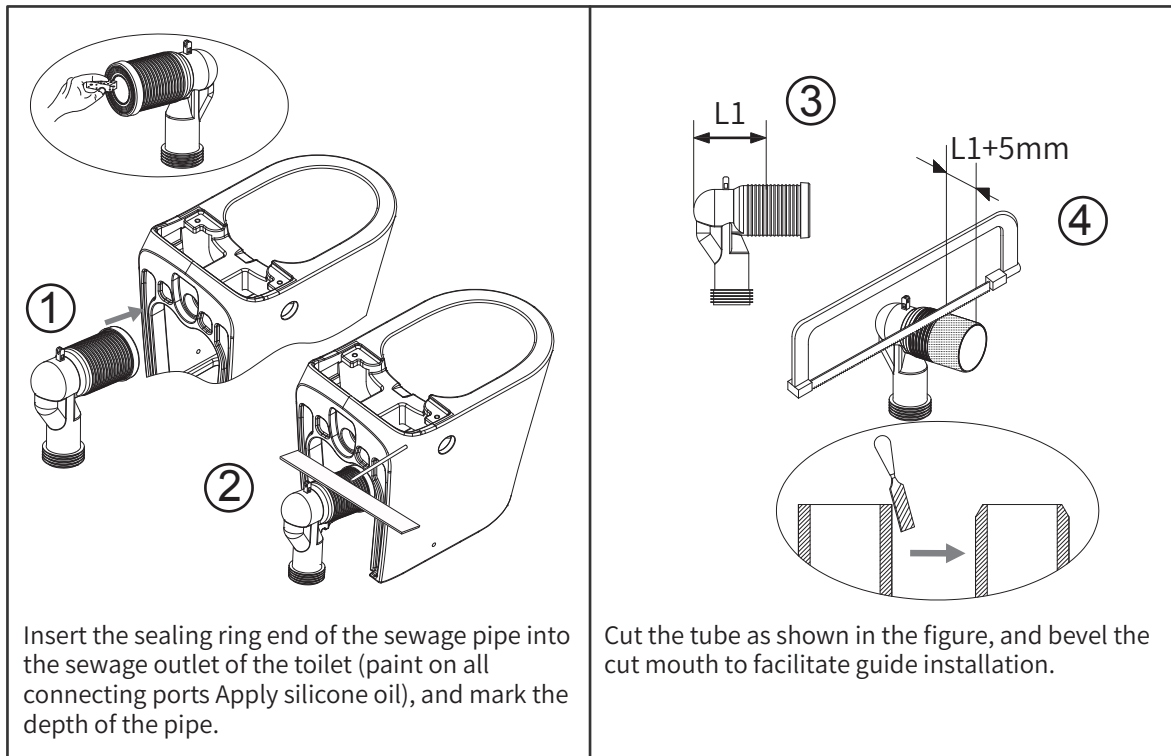



# Product installation

6. Install the drain pipe fitting according to the size and height shown in the figure, and fix it to the wall with bolts.

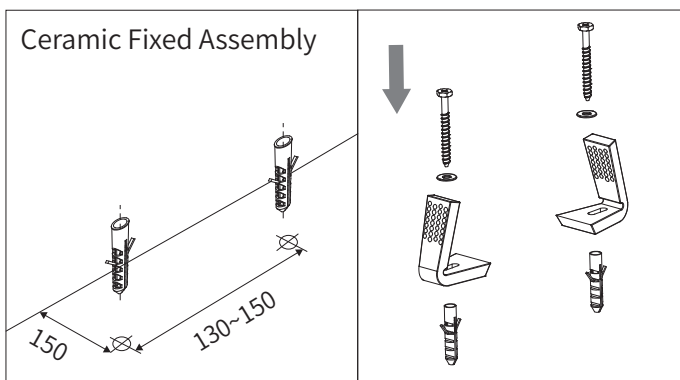
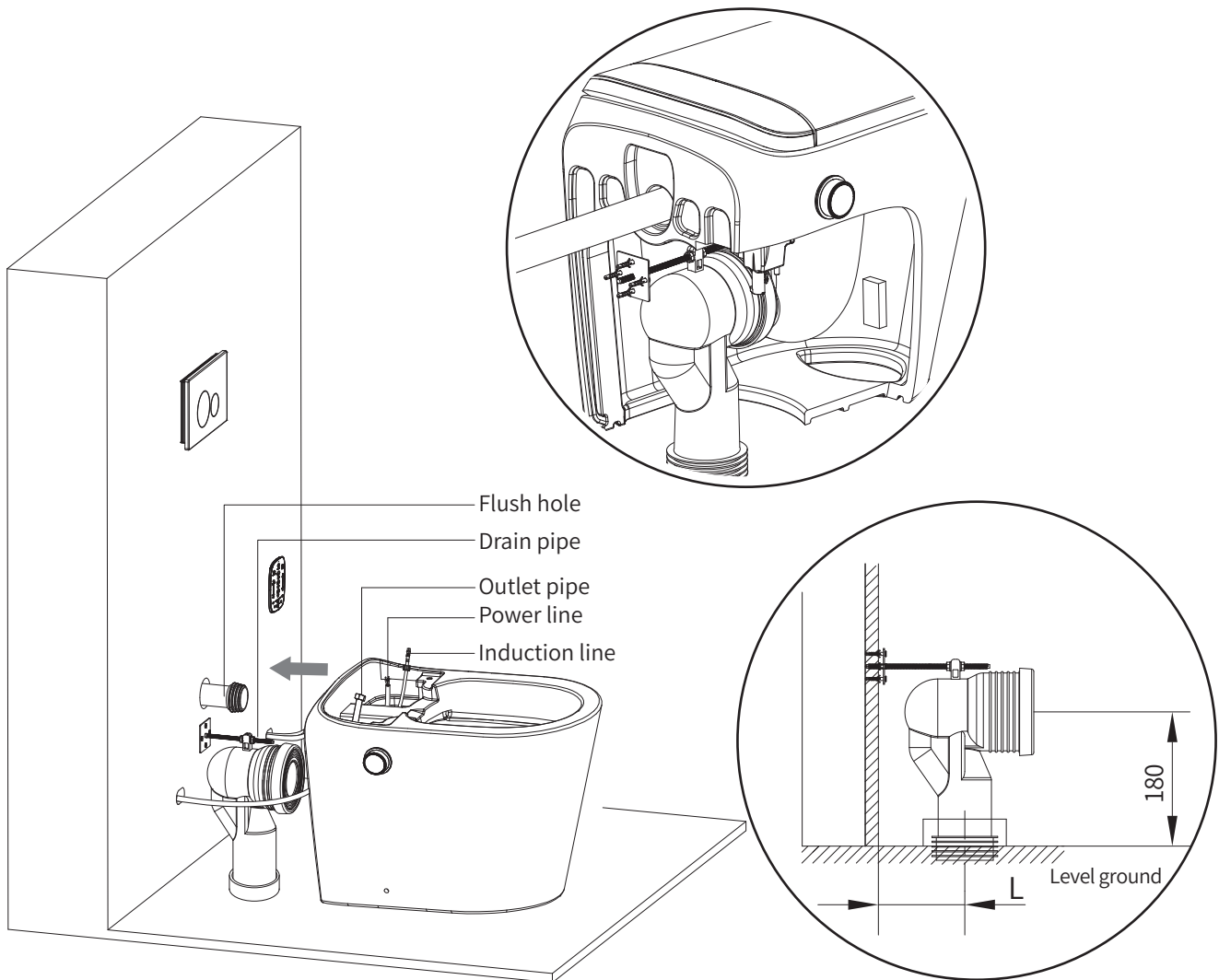

7. Firstly, punch two holes on the floor as shown above, and then fix the plastic expansion pipe to the floor.

The outlet pipe and power cord penetrate into the toilet from the back of the toilet. The flushing holes and drainage holes of the toilet are aligned to the corresponding position, and the toilet moves slowly to the arrow direction and sticks to the wall.

# Product installation

8. After the toilet is close to the wall, use a Spirit Level to measure the product to keep the product in a horizontal position. Then put plastic nylon nut in the electronic cover fixing hole .

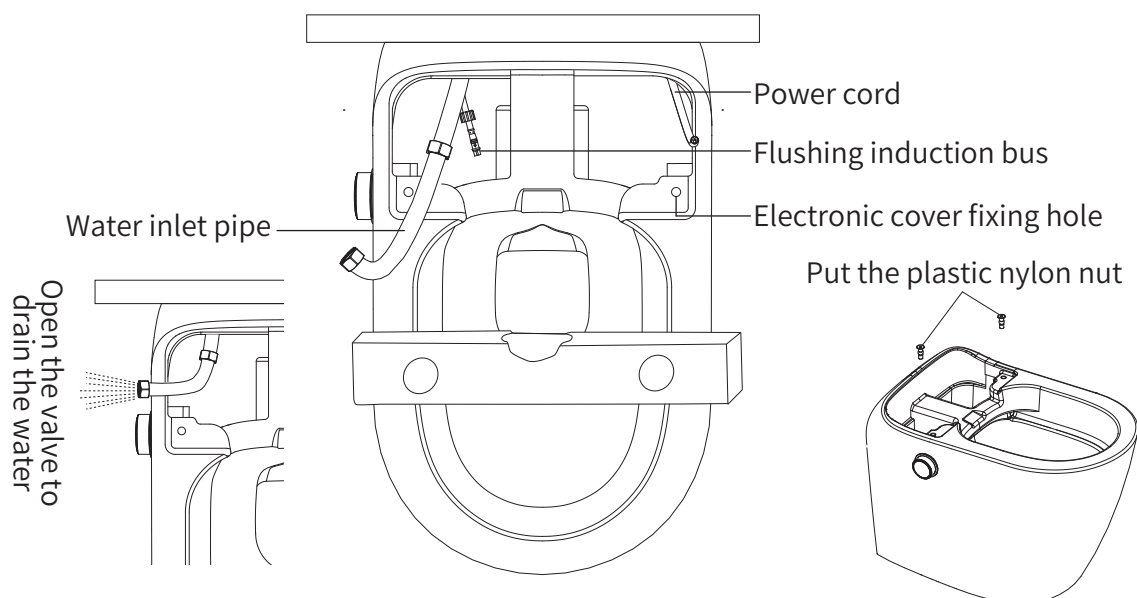

- 9 Put the ceramic fixed components into the ceramic O-shaped hole, lock the small screws and fixing plugs with the ceramic fixed components from the ceramic side, then lock the large fastening screws with the reserved holes on the ground from the ceramic side, and finally the decorative cap is put on the back sleeve.

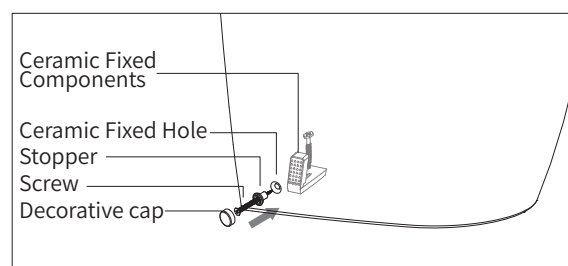

10. After the ambient light wire, knob wire and microwave induction wire are connected, arrange the wires and put them into the wire clip, and then press and hold the wire clip in the direction of closing indicated by the arrow. When you need to take out the wire, press the wire clip in the direction of opening indicated by the arrow.

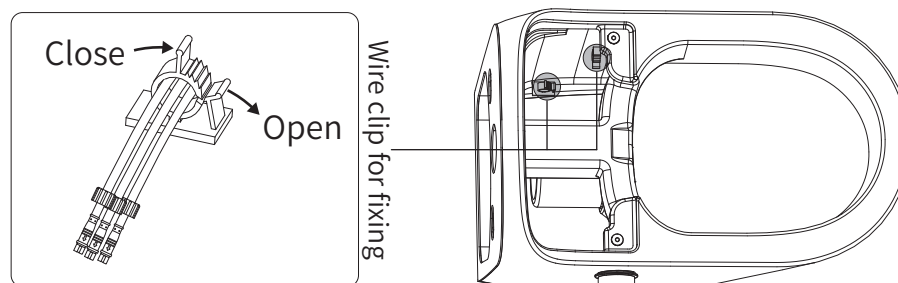

# Product installation

11. Install the power connector cable, Foot sensor cable, knob cable, and microwave induction cable as shown in the figure.

Note: When wiring, you need to disassemble the upper part of the waterproof plug, check whether the ground wire, neutral wire and live wire at both ends correspond to each other, and connect the power wire correctly.

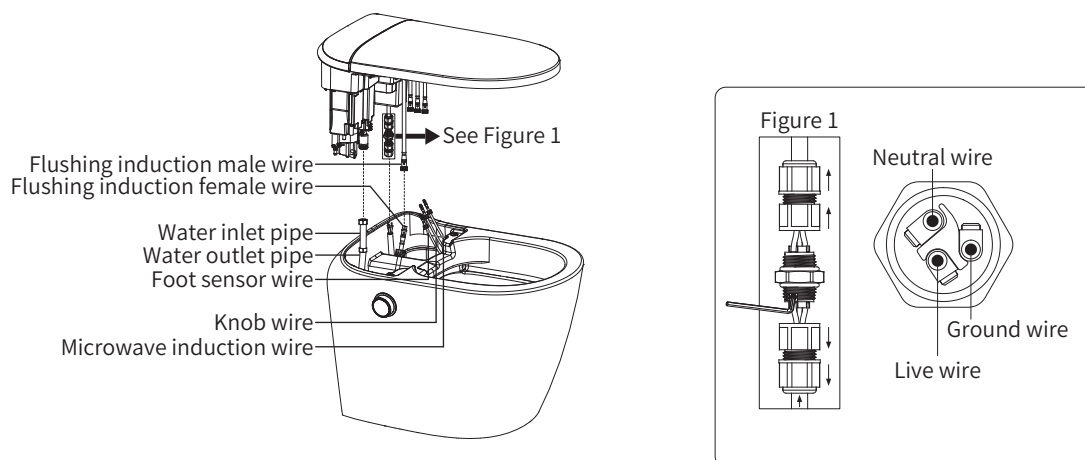

12. Fix the electronic seat on the top of ceramic, tighten it with the fixing screw, and install the decorative cover. The remote control is installed at a distance of about 850mm from the ground, which is easy for users to remove it. When not in the use for a long time, press in the direction of arrow ① to drain the residual water in the pipe. Before replacement or maintenance, pls pull down according to the arrow ② direction below, and drain the residual water inside the tank first.

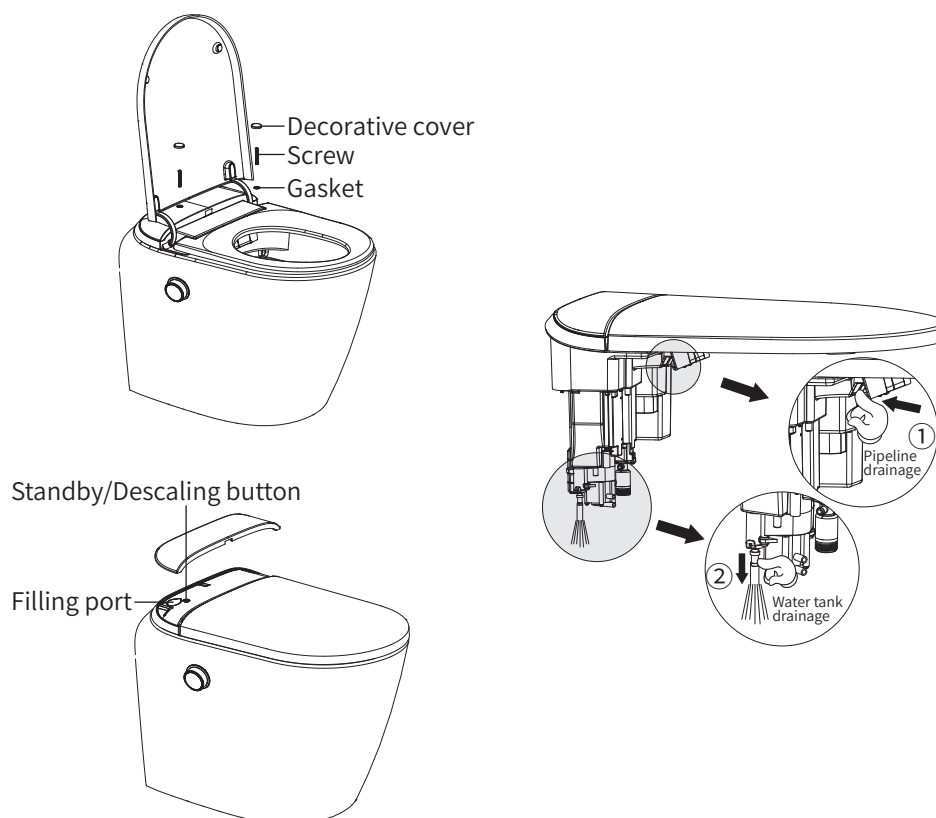

# Instruction for remote control panel

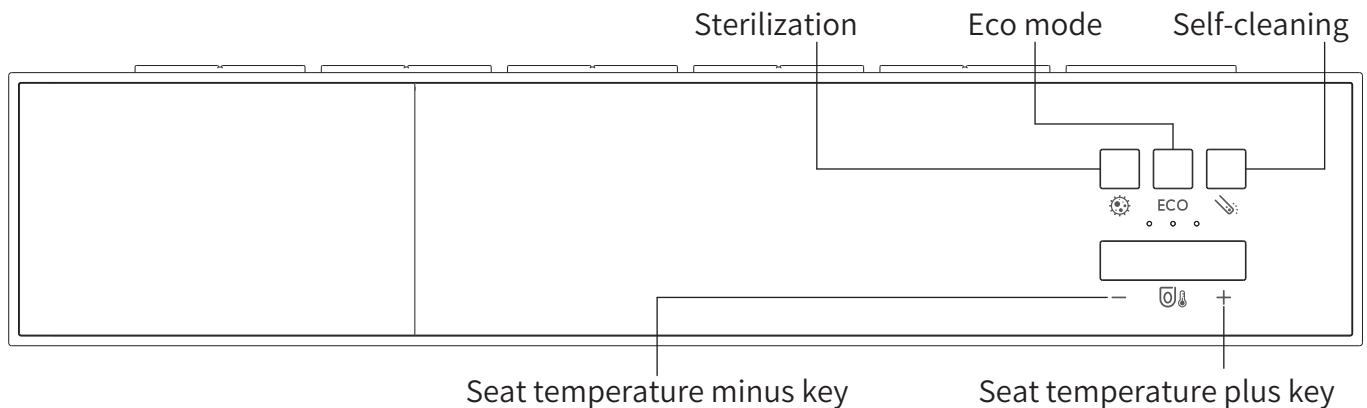
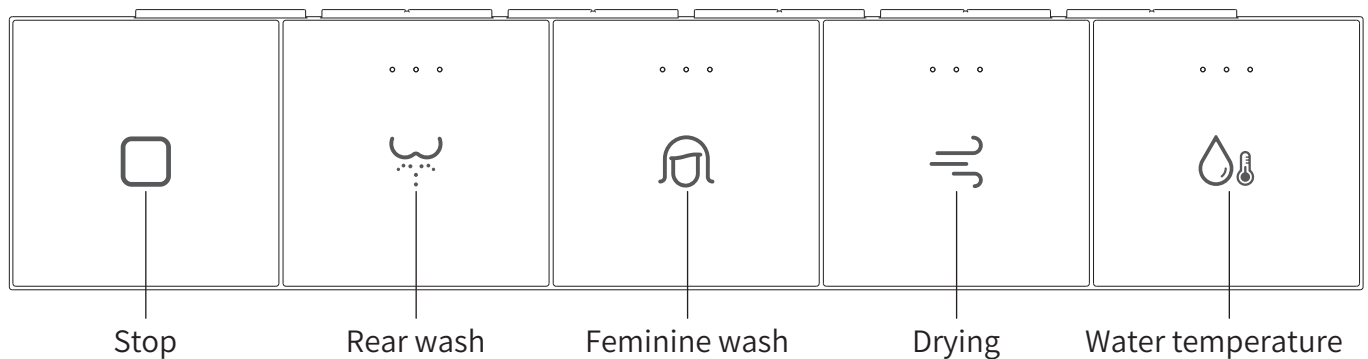
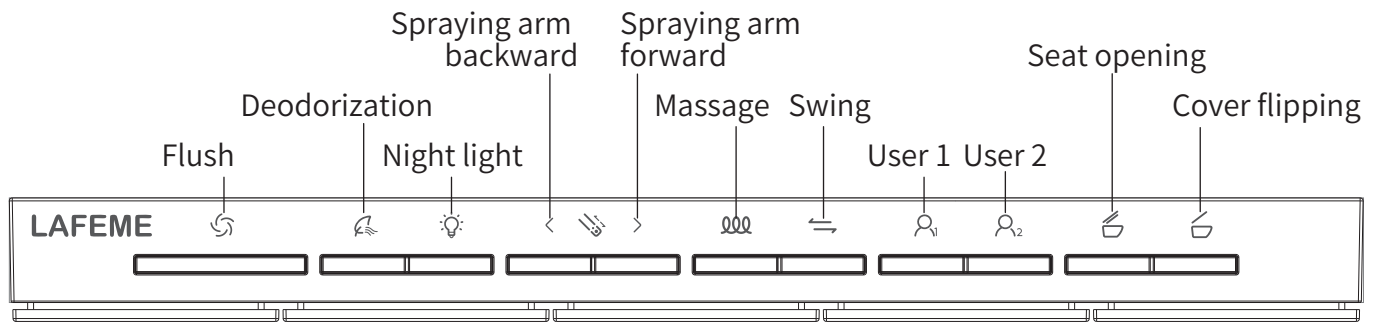

## Remote Code matching:

Press and hold the "Feminine wash + Drying" button at the same time for 5 seconds to enter the code matching mode. The lights on the rear wash, Feminine wash, drying and water temperature buttons flash. In the code-matching mode, press the "Water temp" button to select the corresponding user code, lights of which will light up in sequence from left to right. After selecting the user code, press the "Stop" key to complete the code matching operation.

# Instruction for remote control Installation

## Method 1:

- ① Put the double sided tape on the remote control fixed seat.
- ② Clean dust, grease, water droplets on the walls.
- ③ Press the remote control mounting bracket to adhere with double sided tape on it. Press it evenly for 3 to 5 minutes.

Note: The method is applicable to glazed tiles, glass and smooth wall.

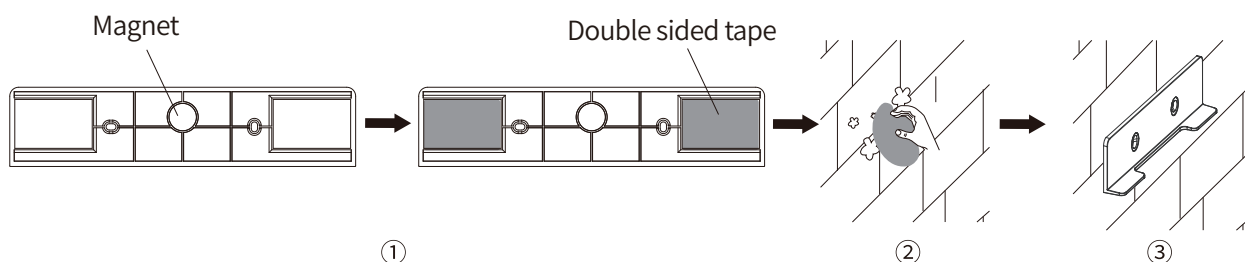

## Method 2:

- ① Drill two holes on the wall with a distance of 3.14 in and a depth of 0.87 in by the drill with the diameter of 0.18 in.

Note: the position of the hole shall be satisfied for user to get the remote control conveniently when sitting on the seat.

- ② After installing, the expansion plug in the wall shall align the fixing hole of the remote control and then lock the bolt.

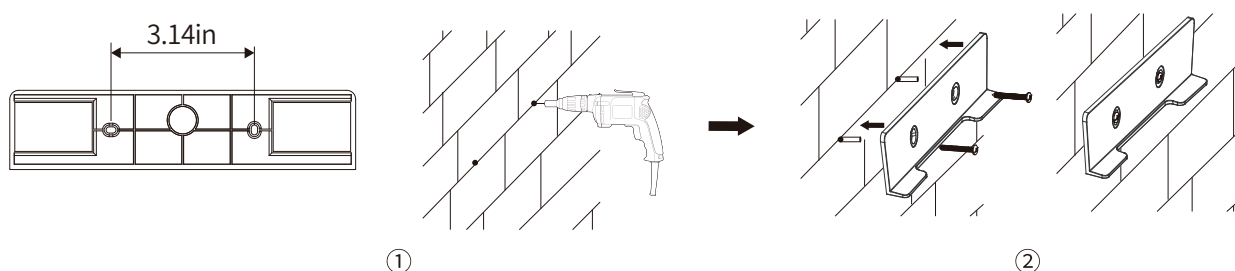

Put the remote control on the mounting bracket after installing the battery.

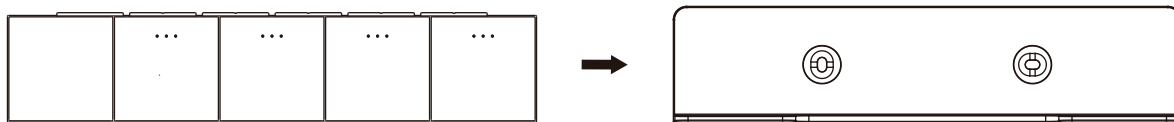

## NOTE:

- ※ Please place the remote control on the fixed place if not use. (To avoid the remote control falling down)
- ※ It may cause damage if the remote control falls down.
- ※ Please do not spill water on the remote control or drop into the water, or it may cause damage.

# Instruction

**Rear wash:** Press the "Rear wash" button and the nozzle extends, and then the rear wash starts.

**Feminine wash:** Press the "Feminine wash" button and the nozzle will extend, and then the feminine wash starts.

**Drying:** Press the drying button to start drying.

**Stop:** Press the "Stop" button to stop the current function. When not seated.

**Deodorization:** When seated, the deodorization function starts. When the user leaves the seat, the deodorization function is turned off (press the "Deodorization" button to turn on or off the seated deodorization function).

**Massage cleaning:** In the state of rear wash or feminine wash, press the "Massage Cleaning" button on the remote control for the first time to start intermittent micro-bubble massage cleaning; and press the "Massage Cleaning" button again to start continuous micro-bubble massage cleaning; and finally press the "Massage Cleaning" button to close the micro-bubble massage cleaning.

**Swing:** In the mode of rear wash or feminine wash, press the "Swing" button to turn on or off swing function. In the state of swing, press the "Spray arm forward" or "Spray arm backward" button to adjust the position.

**Flush:** Press the "Flush" button to start flushing.

**Self-cleaning function:** Press the "Self-cleaning" button, the spray arm can be retracted back and forth, and clean itself.

**Sterilization:** In the off-seat state and the cover is closed, press the "Sterilization" button, the ultraviolet sterilization function is turned on (The knob light and the night light are both blue.) and lasts for 10 minutes. When the cover is opened, the sterilization stops. When the cover is closed, sterilization continues. The duration is not reset.

**Water volume adjustment:** During Rear/Feminine washing, each time you press the "Rear wash" or "Feminine wash" button to adjust the washing water volume accordingly, 3 levels can be adjusted, default setting in level 2.

**Seat temperature adjustment:** Every time you press the "seat temperature plus key", the seat temperature increases by one level. Every time you press the "Seat temperature minus key", the seat temperature decreases by one level, and the three levels of addition and subtraction can be adjusted and turned off, and the corresponding gear indicator lights up separately.

**Air temperature adjustment:** Press the "Dry" button to start drying. In the drying state, every time you press the button, the air temperature will be adjusted by one level, and 3 levels will be cyclically adjustable or off.

**Water temperature adjustment:** During Rear/Feminine washing, each time you press the "Water temperature" button, the water temperature is adjusted by one level, 3 levels can be cyclically adjusted and closed (long press the "Water temperature" button to close), default setting in level 2, and the corresponding level indicator light is on.

**Nozzle position adjustment:**

Press the "Spray arm forward" or "Spray arm backward" button on the remote control, the nozzle moves forward or backward by one gear. Move to the limit position, and then press the "Spray arm forward" or "Spray arm backward" button, the nozzle does not move.

**Cover flipping:** Press the "Cover flipping" button to control the opening and closing of the Lid.

**Seat flipping:** Press the "Seat flipping" button to control the opening and closing of the seat.

**Eco mode:**

1. After pressing the "Energy Saving" button, the seat temperature will be automatically adjusted to the lowest level when the seat temperature is heated, and it will remain closed when the seat temperature heating is turned off.

2. In the energy-saving mode, all light displays are turned off.

3. In the energy-saving mode, the seating sensor detects that someone is seated, and automatically stops the energy-saving mode, and automatically enters the energy-saving mode after the user leaves the seat.

4. Press the "Energy Saving" button to turn on or off the energy saving mode function.

**Night light function:** Control the night light on and off according to the light intensity of the bathroom through the light sensitivity of the toilet body.

Short press the "night light" button to turn off the light-sensitive response function and long press the "night light" button to turn on the light-sensitive response function.

The factory defaults to turn on the night light, short press the "night light" button to turn off or turn on the night light always-on function.

**User 1/User 2 customization:**

Under the current use of "water temperature, water volume, spray arm position, air temperature", press and hold the "User 1 or User 2" button for more than 2 seconds, the current use setting can be set to the favorite custom button, and all the indicators on the remote control panel flashes twice, the settings you like have been saved. Press "User 1 or User 2" directly next time, and all gear indicators on the remote control panel will be on for one second. Press the rear wash or Feminine wash button based on your need.

**Combination button:**

Long press "Stop + Seat temperature plus" button to turn on or off the foot flushing function.

Long press the "Stop + Swing" button to turn on or off the sensor flip-up function.

Long press the "Stop + Massage cleaning" button to turn on or off the function of opening or closing the lid by foot sensor.

Long press the "Stop + Cover flipping" button to turn on or off the automatic function of closing the cover and the seat.

# Description of Knob Function

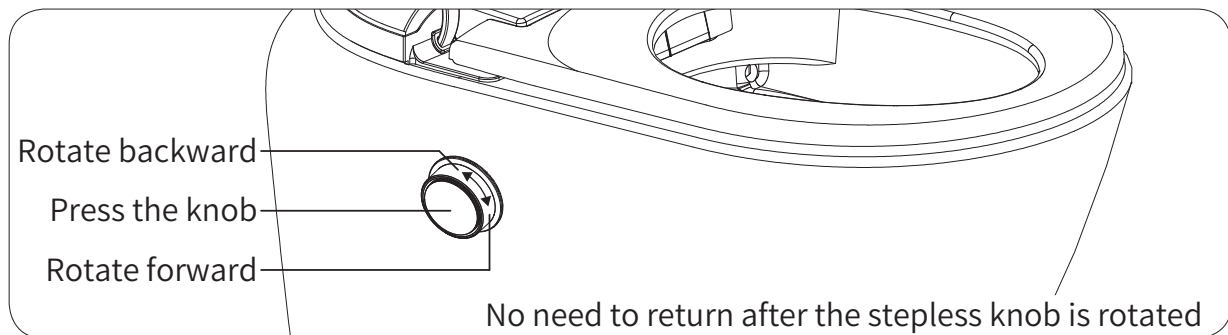

## **In the seated state (The light is always bright white):**

1. Rotate the knob forward to activate the Feminine Wash function, and rotate the knob backward to activate the Rear Wash function.
2. Under the the function of Feminine Wash, Rear Wash or Drying, short press the knob to stop Feminine Wash, Rear Wash or Drying.
3. In the non-functional operation state, short press the knob to flush once.
4. Long press the knob for about 3 seconds to start drying.
5. Long press the knob for more than 10 seconds to turn on or off the remote control function, during which the drying is turned on normal phenomena.
6. In the state of Feminine Wash or Rear Wash, rotate the knob forward or backward, and the nozzle moves forward or backward.
7. In the Drying state, rotate the knob forward to increase the air temperature, and rotate the knob backward to decrease the air temperature.

## **In the non-seated state (The light is white-breathing light):**

short press the knob to flush once.

# Description of Other Functions

## **Auto flush:**

After the user leaves the seat, it will automatically flush once.

## **Nozzle sterilization:**

After the user is away from the seat for 1 minute, the nozzle will automatically perform a deep ultraviolet sterilization for 2 minutes, and the sterilization will stop when it is seated again during the sterilization period.

## **Standby function (Sleep mode):**

In the non-seated state and not in the descaling state, short press the "standby/descaling" button to turn off all the functions and lights and enter the standby state.

## **Automatic opening or closing of lid/seat:**

When a person is close to the ceramic induction area, the lid automatically open;

When the lid is opened and the seat is closed, please touch the foot sensing area with the foot, and the seat will open;

When the lid and seat is opened, please touch the foot sensing area with the foot, and after lid and seat closes it will perform a flush.

After 90 seconds of non-functional operation and leaving the seat, the lid and seat will be automatically closed in turn, and the induction flip function will only be available after closing the lid for 5 seconds.

## **Pipeline descaling:**

In the non-seated state, after adding descaling liquid, long press the "standby/descaling" button to turn on or off descaling. During descaling, the knob light is green breathing light. Please use a descaling agent whose main ingredients are food-grade citric acid and organic acid.

Dosage: Mix an appropriate amount (solid: 30-40g or liquid: 30-40ml) descaling agent with 50ml of water and stir until they are fully mixed or dissolved, and then pour the descaling solution from the product inlet. It is recommended to descale every 2-3 months.

# Trouble Shooting

The product not operating	Whether the power supply is plugged in or the leakage protector is disconnected	Switch the power supply
No response when press the button of posterior cleaning & feminine cleaning & drying	No water outflow from nozzle or the water yield is very low.	Please press the stop button and wait for the water supply to reactivate.
		Please open the water-inflow valve if it is closed.
	The continuous use more than one hour will activate safety sensor	For safety cutoff, please stand up and sit down again.
	The sensor is not sensing that someone is seated	Please sit down in a correct position.
Self cleaning mode in the nozzle	The nozzle will stretch out to proceed self-cleaning after pressing the button of posterior cleaning or feminine cleaning.	This is normal operation, and just need to wait for several seconds.
The nozzle stops cleaning suddenly when it's on work	The nozzle stops spraying after cleaning for a period of time, then reactivates after 120 seconds.	This is normal operation for safety purpose.
The nozzle stops cleaning suddenly	If the user moves too fast or leaves the seat, the seat sensor cannot detect in a short time.	Sit back on the seat sensor detection position, then start the relevant button.
Low water pressure when posterior cleaning or feminine cleaning	The water-inflow hose may be leaking	Call the installer to check the hose and tighten it.
Deodorization effect is not obvious	The seat sensor is not sensing person and no deodorization sound	Sit back on the seat sensor detection position.
	Activated carbon filter block or spacer may be blocked	Remove the deodorizing window to clean or replace the activated carbon filter.
Deodorization continues to work after user leaves	The Deodorization will be continue to work for 20 seconds in order to remove the residual odor after the user leaves.	This is normal operation for safety purpose.



# Trouble shooting and alarm maintenance

Phenomenon	Reasons	Measures
If the power light flashes 1 time as it lights for 2 seconds	It can be detected that inlet water temperature sensor is faulted or broken circuit	You should cut off the power supply immediately and stop using the product, then contact the local dealer or call service hotline.
If the power light flashes 2 times as it lights for 2 seconds	It can be detected that outlet water temperature sensor is faulted or broken circuit	
If the power light flashes 3 times as it lights for 2 seconds	It can be detected that air temperature sensor is faulted or broken circuit	
If the power light flashes 5 times as it lights for 2 seconds	It can be detected that the seat temperature sensor is faulted or broken circuit	
If the power light flashes 7 times as it lights for 2 seconds	It can be detected that the dryer fan is faulted	

## ※WARM PROMPT

If you are in trouble with your smart toilet, please read the above trouble shooting and repair the product according to the instruction of the solution. If the problem is not in the common troubleshooting, please contact the professionals, dealers, or call the national unified service hotline to ask for help.

Please note that there will not be any notification if any changes to this product and also accessories. There may be difference between contents and material objects, please subject to the latter one.

# Maintenance Service Sheet

## Appendix 1:

Product model		Invoice number	
Retailer Name		Purchase Date	
State	Suburb	Dealer ( signature ):	
Repair content			
<p><b>Maintain regulation:</b></p> <ol style="list-style-type: none"> <li>1. Maintenance is provided when you use it properly in accordance with instructions and under warranty.</li> <li>2. Please contact the dealer or the company if the fault occurs under warranty.</li> <li>3. Although during the warranty period, the following situations need to be repaired for extra charge: <ol style="list-style-type: none"> <li>① Faults or damages caused by the improper operation, repair or installation.</li> <li>② Faults or damages caused by forced movement after the product is installed.</li> <li>③ Faults or damages caused by natural disasters (earthquakes, fires, floods, lightning strikes and other natural disasters) or corrosive liquids or abnormal voltage.</li> <li>④ Faults or damages caused by other approaches which are not for domestic use.</li> <li>⑤ Fail to provide the maintenance-service sheet or proof of purchase.</li> </ol> </li> <li>4. This maintenance-service sheet is unrepeatable, please take care of it.</li> </ol>			
client stub			

Cut-line

## Appendix 2:

Client	Name			
	Address			
Product model		Manufacture	LAFEME	
The selling store		Purchase date		
Executive standard		Warranty period	Within two years from the purchase date	

# Maintenance record



Cut-line

